





316L Stainless Round Clear Out 100mm Outlet

Finish & SKU

 PVD Black NRFW010PB	 Brushed Nickel NRFW010BN
 Brushed Bronze NRFW010BZ	 Brushed Gold NRFW010BG
 Graphite NRFW010GR	



Specifications

Watermark License

WM-032203

Temperature Rating

Min 1°C-Max 75°C

Pressure Rating

Min 150kpa-Max 500kpa

Warranty



Features

- 316L stainless steel construction
- O-ring seal to prevent odour leakage
- Push-fit design for 100mm DWV pipe"

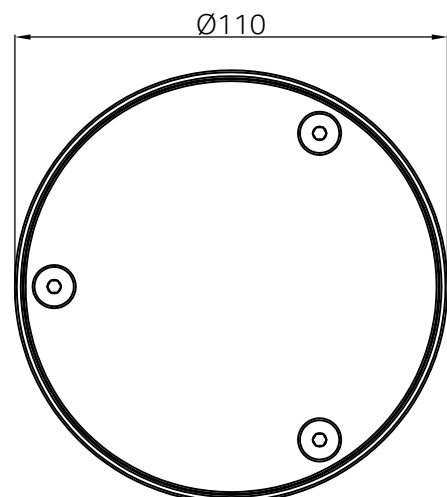
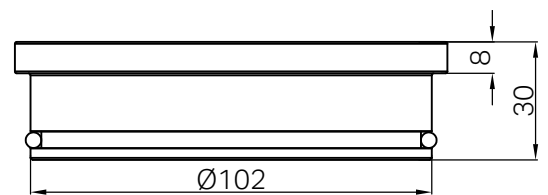

Maintenance And Care

- Regularly check the mixer and connections for signs of wear or leaks.
- Clean the tap with mild soapy water to maintain its appearance, avoiding harsh chemicals and abrasive materials that may damage the finish.

- Dimensions are nominal measurements only.