

## Celia Wall Basin/Bath Mixer Separate Back Plate

### Finish & SKU



**Chrome**  
NR301510bCH



**Brushed Nickel**  
NR301510bBN



**Matte Black**  
NR301510bMB



### Specifications

#### Watermark License

WM-060073

#### Temperature Rating

Min 1°C-Max 75°C

#### Pressure Rating

Min 150kpa-Max 500kpa

### Warranty



Lead Free

### Features

- 35mm ceramic disc cartridge can be adjusted to control water temperature and flow control settings, saving energy
- Solid brass construction for longevity
- Water inlets- 1/2 BSP female
- Suitable for mains pressure installation
- Replaceable trim kits
- Packed separately (Body and Trim Kits)
- Includes an additional non-restricting aerator for bath use.

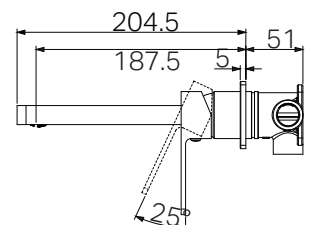
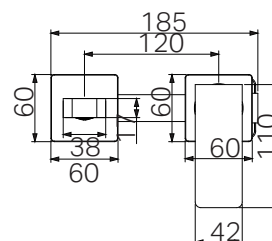

### Maintenance And Care

- Regularly check the mixer and connections for signs of wear or leaks.
- Clean the tap with mild soapy water to maintain its appearance, avoiding harsh chemicals and abrasive materials that may damage the finish.

- Dimensions are nominal measurements only.