

Mecca Shower Mixer Diverter System Separate Back Plate Trim Kits Only

Nero

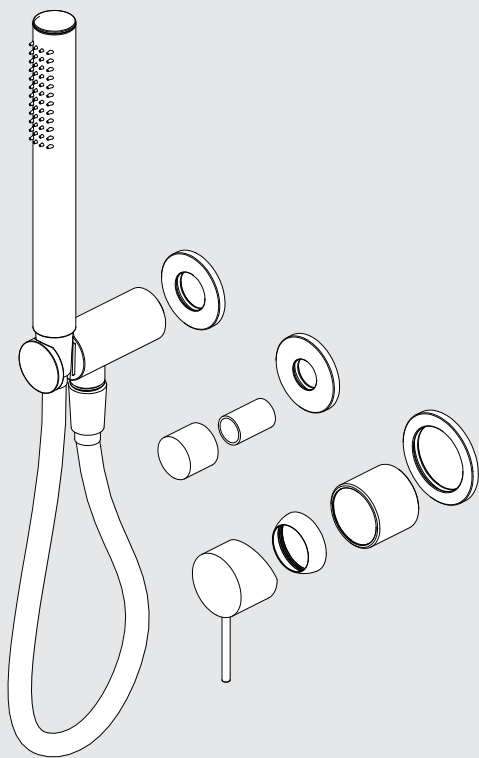

Lead Free



Versions:202506

Drawing

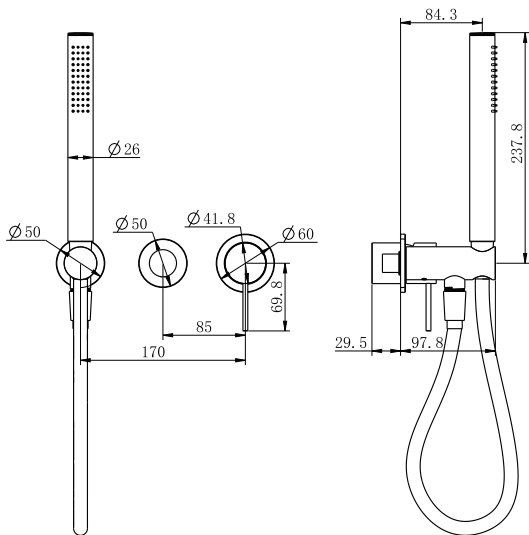

Specifications

Watermark License
WM-060073
Temperature Rating
Min 1°C-Max 75°C
Pressure Rating
Min 150kpa - Max 500kpa

Packaging Includes

- 3x Plates
- 1x Handle
- 1x Cartridge Bell
- 1x Dressing Ring
- 1x Hand Shower
- 1x Hose
- 1x Bracket
- 1x Knob
- 1x Sleeve

Finish & SKU

Chrome NR221912ftCH	Gun Metal NR221912ftGM	Brushed Bronze NR221912ftBZ	Brushed Nickel NR221912ftBN
Matte Black NR221912ftMB	Brushed Gold NR221912ftBG	Matte White NR221912ftMW	

*Dimensions are nominal measurements only.

Installationinstruction For Shower System Trim Kits Only

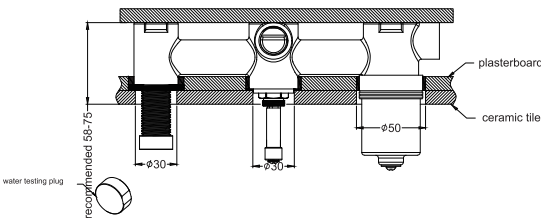

1. Drill a 50mm hole and two 30mm holes into the ceramic tile, then proceed to install the ceramic tile as shown in the diagram above.
2. Remove the water testing plug

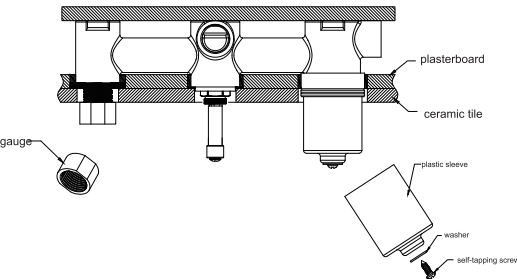

4. Remove the gauge, self-tapping screw, washer, and plastic sleeve in sequence.

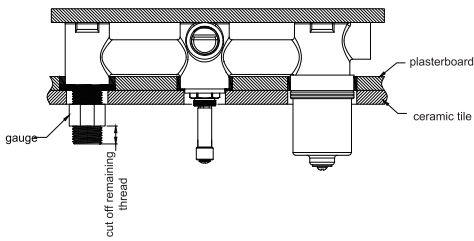

3. Put gauge onto the outlet as above picture. And cut off remaining thread using the provided gauge as a guide.

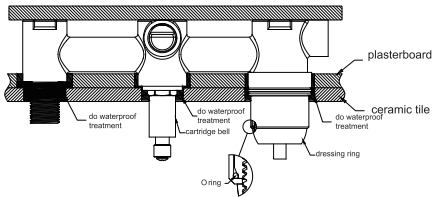

5. Insert the O ring to the dressing bell groove, and slide the dressing bell onto cartridge.
6. Apply waterproof treatment to the three areas indicated in the diagram above.
7. Tighten up the dressing ring on the cartridge bell, and slide Diverter cartridge bell onto the cartridge.

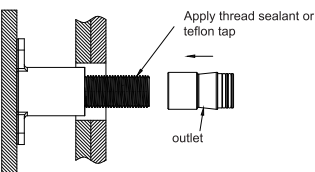

8. Apply thread sealant or Teflon tape to the outlet thread, then use a wrench to tighten the outlet onto it.

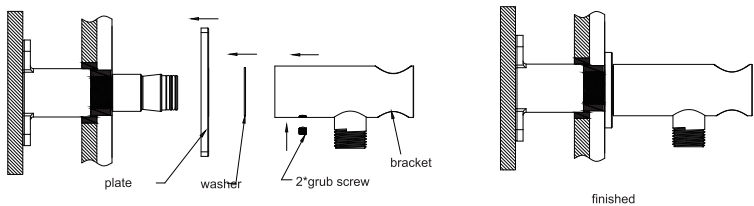

9. Install the plate, washer, and bracket onto the outlet body in the order shown above.

Installationinstruction For Shower System Trim Kits Only

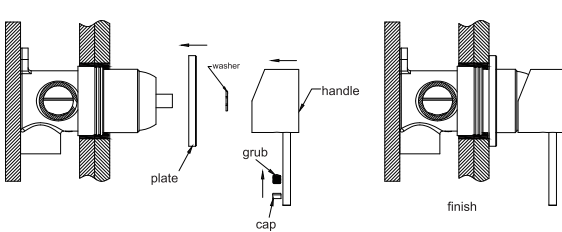

10. Slide plate onto body, attach the washer to the cartridge, position the handle, tighten it with a grub screw using an Allen key, and cap the grub screw hole.

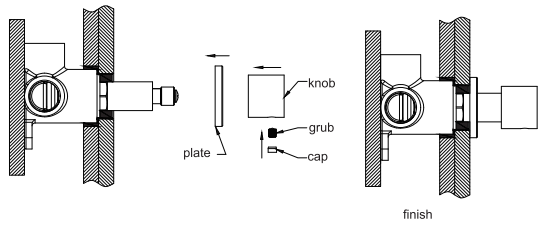

11. Slide plate onto body, position the diverter knob, tighten it with a grub screw using an Allen key, and cap the grub screw hole.

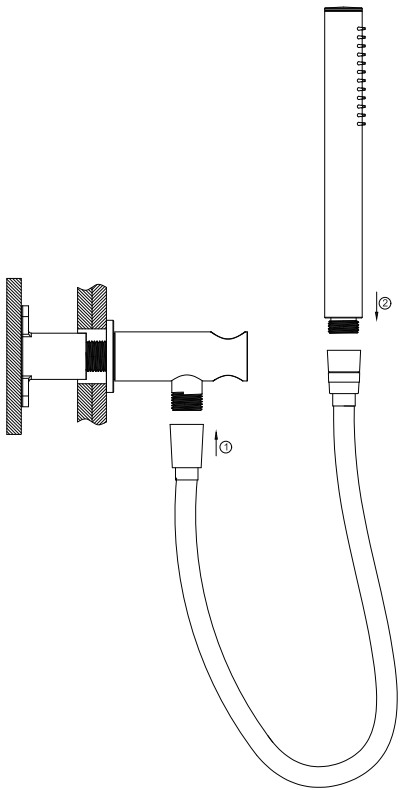

12. Connect the hand shower to the bracket with the hose.

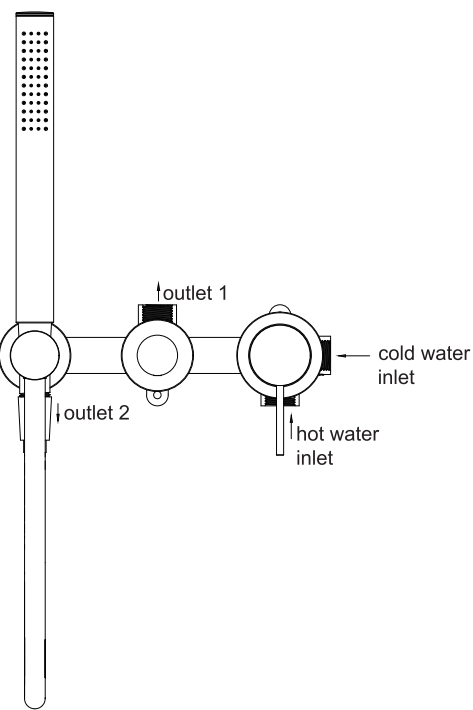

13. TEST & CHECK FOR LEAKS.

Nero

