

# Dolce II Rail Shower

# Nero

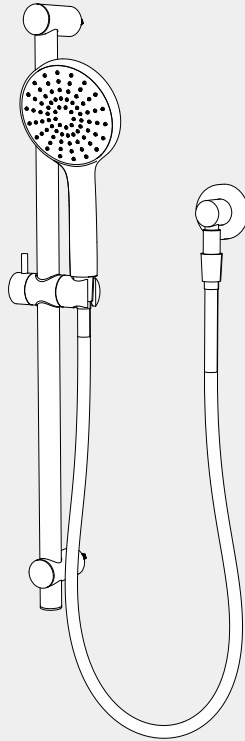

Version : 202508a



## Drawing

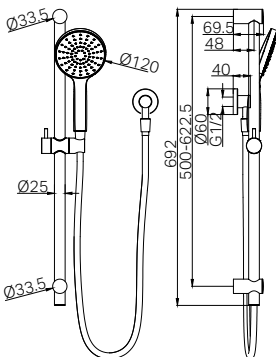

## Specifications

**Watermark License**

WM-060093

**Temperature Rating**

Min 1°C–Max75°C

**Pressure Rating**

Min 150kpa - Max 500kpa

## Package Includes

- 1 x Hand Shower
- 1 x Shower Rail
- 1 x Elbow
- (Built-in Dual-Check Valve)
- 1 x 1.5m Shower Hose

## Finish & SKU

 **Chrome**  
NR322CH

 **Matte Black**  
NR322MB

 **Gun Metal**  
NR322GM

 **Brushed Gold**  
NR322BG

 **Brushed Nickel**  
NR322BN

\*Dimensions are nominal measurements only.

# INSTALLATION INSTRUCTIONS

## GENERAL INSTRUCTIONS:

- This product must be installed by a licensed plumber. Ensure that your plumbing installation complies with the Australian/New Zealand Standard AS/NZS 3500.
- All pipework must be thoroughly flushed prior to the installation of the mixer. In-line filters must be fitted on both hot and cold supplies to prevent foreign particles from damaging the ceramic cartridge.
- Ensure that all outlets used for personal hygiene deliver water at a safe temperature in accordance with regional regulations.
- Verify that the water pressure is within the recommended range for the shower to function properly.

## PARTS NAME

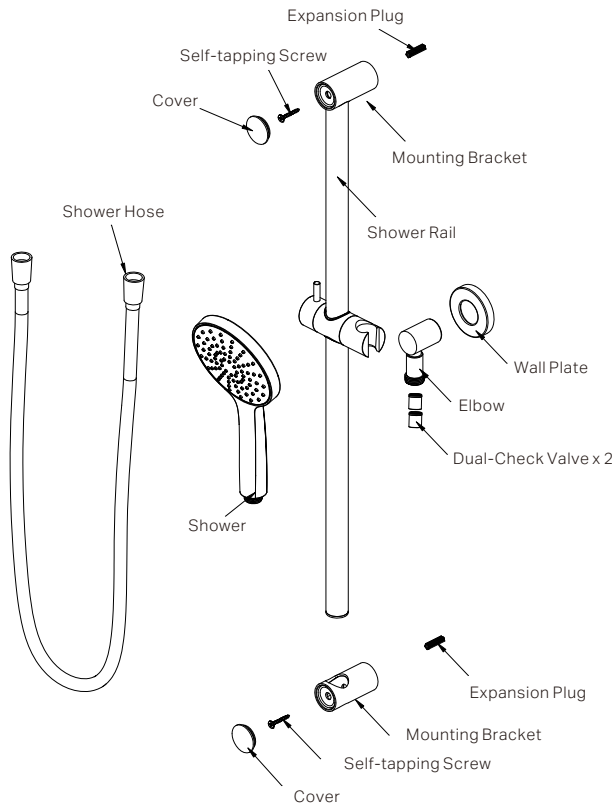

## INSTALLATION STEPS

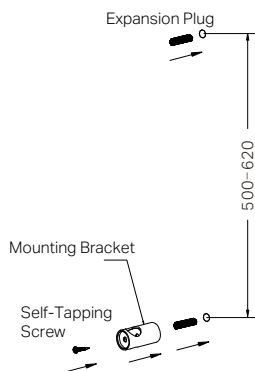
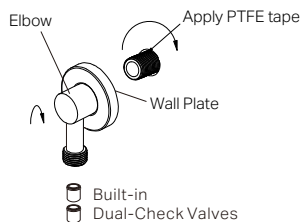

01. Apply PTFE tape to the outlet thread.
02. Slide the wall plate to the elbow and screw the elbow onto the outlet thread.

03. Drill two  $\varnothing 6$  mm mounting holes on the same vertical line, 500–620mm apart, push the expansion plugs into mounting holes.
04. Secure the bottom mounting bracket to the wall with self-tapping screw.

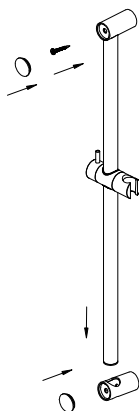

05. Insert the rail into two mounting brackets. Secure the upper mounting bracket and rail to the expansion plug using self-tapping screw. Press the covers onto the upper and lower mounting brackets respectively.

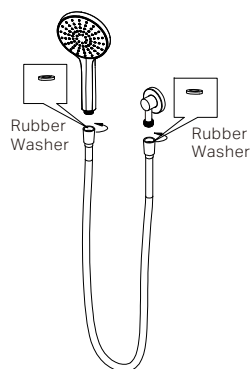

06. Connect the hand shower to the elbow using the provided shower hose. Note: Ensure rubber washers are in place at both ends of the shower hose to prevent leaks.

## FINAL INSPECTION

Switch on the water supply and check for any leakage at the joints.

# Nero

