

# Project Pop-up Waste

Nero

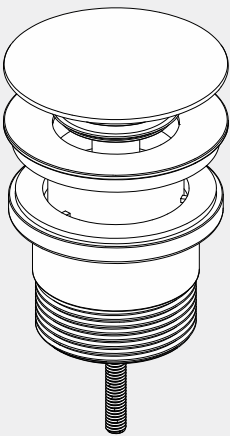

Version : 202509

## Drawing

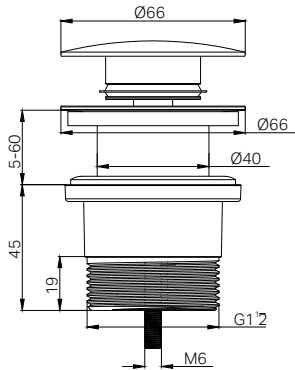

## Features

**SKU**  
NRA711  
**Watermark License**  
WMK26021

## Packing Includes

1x Pop-up Waste

## Finish & SKU

- |                                                                                                                    |                                                                                                                     |                                                                                                                       |
|--------------------------------------------------------------------------------------------------------------------|---------------------------------------------------------------------------------------------------------------------|-----------------------------------------------------------------------------------------------------------------------|
|  <b>Chrome</b><br>NRA711CH      |  <b>Gun Metal</b><br>NRA711GM    |  <b>Brushed Nickel</b><br>NRA711BN |
|  <b>Matte Black</b><br>NRA711MB |  <b>Brushed Gold</b><br>NRA711BG |                                                                                                                       |

\*Dimensions are nominal measurements only.

## INSTALLATION INSTRUCTIONS

### GENERAL INSTRUCTIONS:

The Nero Pop-up Waste (Model NRA711) is designed to suit basins with a 40 mm waste outlet. Installation should be carried out by a licensed plumber and in accordance with Australian standards.

### MAINTENANCE AND CARE:

- Clean the basket waste with a soft, damp cloth. Avoid using abrasive cleaners, which can damage the finish.
- Regularly remove and clean the strainer to prevent blockages.
- Keep the drain dry when not in use to prevent corrosion.

## PART NAMES

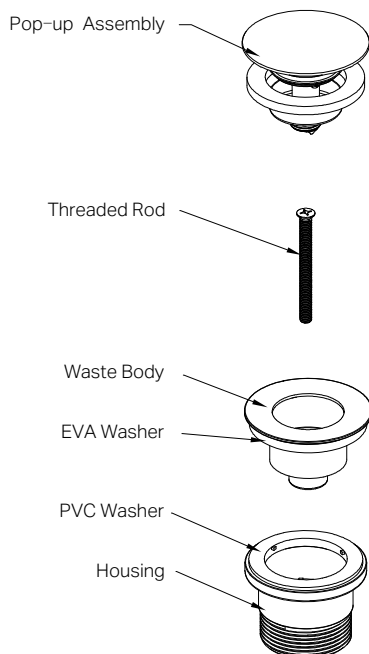

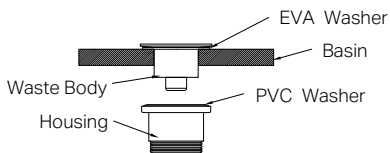
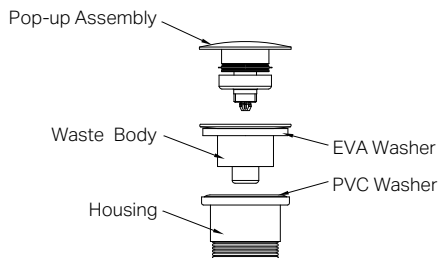

1. Carefully disassemble the product into the following components:

Pop-up assembly

Waste body with EVA washer

Housing with PVC washer.

2. Insert the waste body through the basin hole from the top side. Ensure the EVA washer is positioned correctly against the basin.

3. Place the housing with PVC washer underneath the basin.

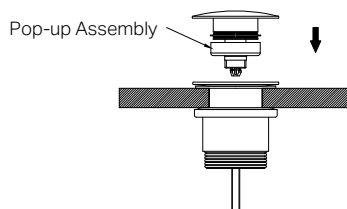
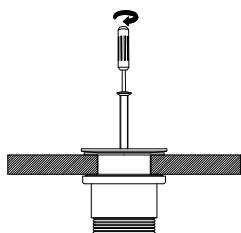

4. Using a cross screwdriver, tighten the threaded rod to secure the waste body and the housing.

Important: Do not exceed a tightening torque of 40N.

5. Insert the pop-up assembly into the waste body.

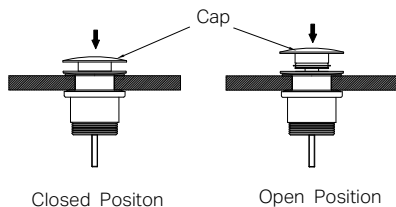

6. Installation is now complete. (Press the top cap to switch between open and closed positions.)

Nero

