

Short Pop Up Bath Waste 40mm

Nero

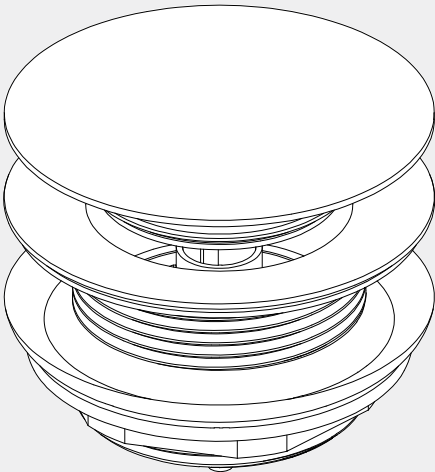

Version : 202505

Drawing

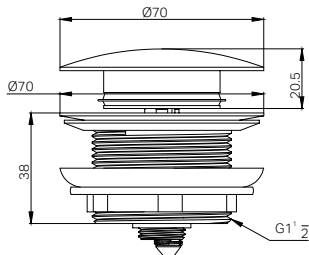

Features

Durable Brass Construction
Compact Design for Tight Spaces
Smooth Click-Clack Operation
Standard 40mm Outlet Connection

Packing Includes

1x Short Pop-up Bath Waste

Finish & SKU

Chrome
NRA709CH

Matte Black
NRA709MB

Matte White
NRA709MW

Gun Metal
NRA709GM

Brushed Gold
NRA709BG

Brushed Nickel
NRA709BN

Brushed Bronze
NRA709BN

*Dimensions are nominal measurements only.

INSTALLATION INSTRUCTIONS

GENERAL INSTRUCTIONS

(Applicable for Australia & New Zealand installations)

- Ensure all parts are present and undamaged before commencing installation. Do not proceed if components are missing or defective.
- This product is suitable for a 40mm waste outlet.
- Compatible with bathtub waste holes ranging from 51mm to 55mm in diameter.
- Installation must comply with AS/NZS 3500 plumbing standards and should be carried out by a licensed plumber.
- Do not overtighten components during assembly. Excessive force may damage sealing washers or the bathtub surface.
- Test for leaks upon completion by filling the tub and checking around the waste body and overflow connection.
- Bath overflow installation kit is not included.

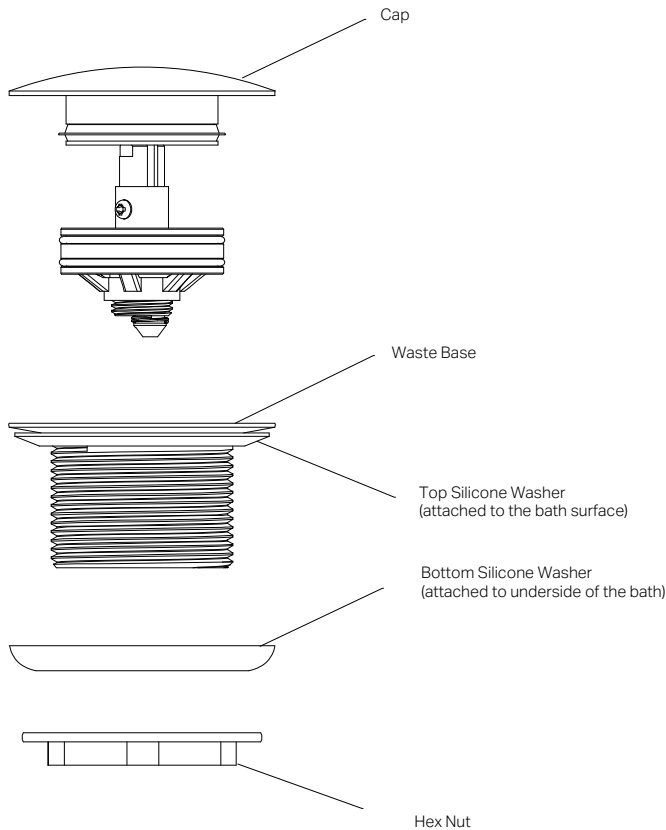

INSTALL STEPS

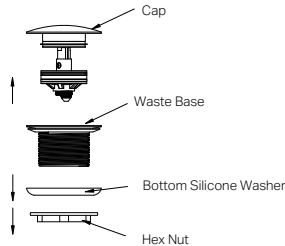

01. Remove the cap, hex nut, and bottom silicone washer from the waste base.

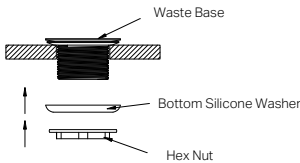

02. Insert the waste base through the bathtub hole, slide the silicone washer up against the underside of the tub, and secure the assembly from underneath using the hex nut.

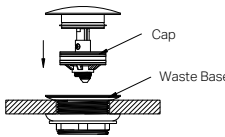

03. Insert the cap into the waste.

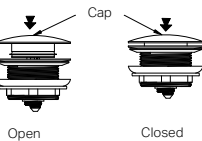

04. Press the cap to toggle between open (drain) and closed (seal) modes. Check for leaks after installation.

MAINTENANCE AND CARE

To maintain optimal performance, clean the silicone washers and waste area periodically to prevent buildup of debris or residue.

Nero

